

I, J.B. PARKER of Buffalo, Wyo. HEREBY CERTIFY THAT THIS MAP WAS MADE FROM NOTES TAKEN DURING AN ACTUAL SURVEY MADE BY ME ON MARCH 12th 1904 AND THAT IT CORRECTLY REPRESENTS THE HAMILTON ADDITION TO THE CITY OF BUFFALO, WYO. COMPRISING ALL OF THE NE¹/₄ SW¹/₄ SEC. 35, Twp. 51 N., R. 22 W.

J.B. Parker,
SURVEYOR.

SCALE - ONE INCH = 120 FT.

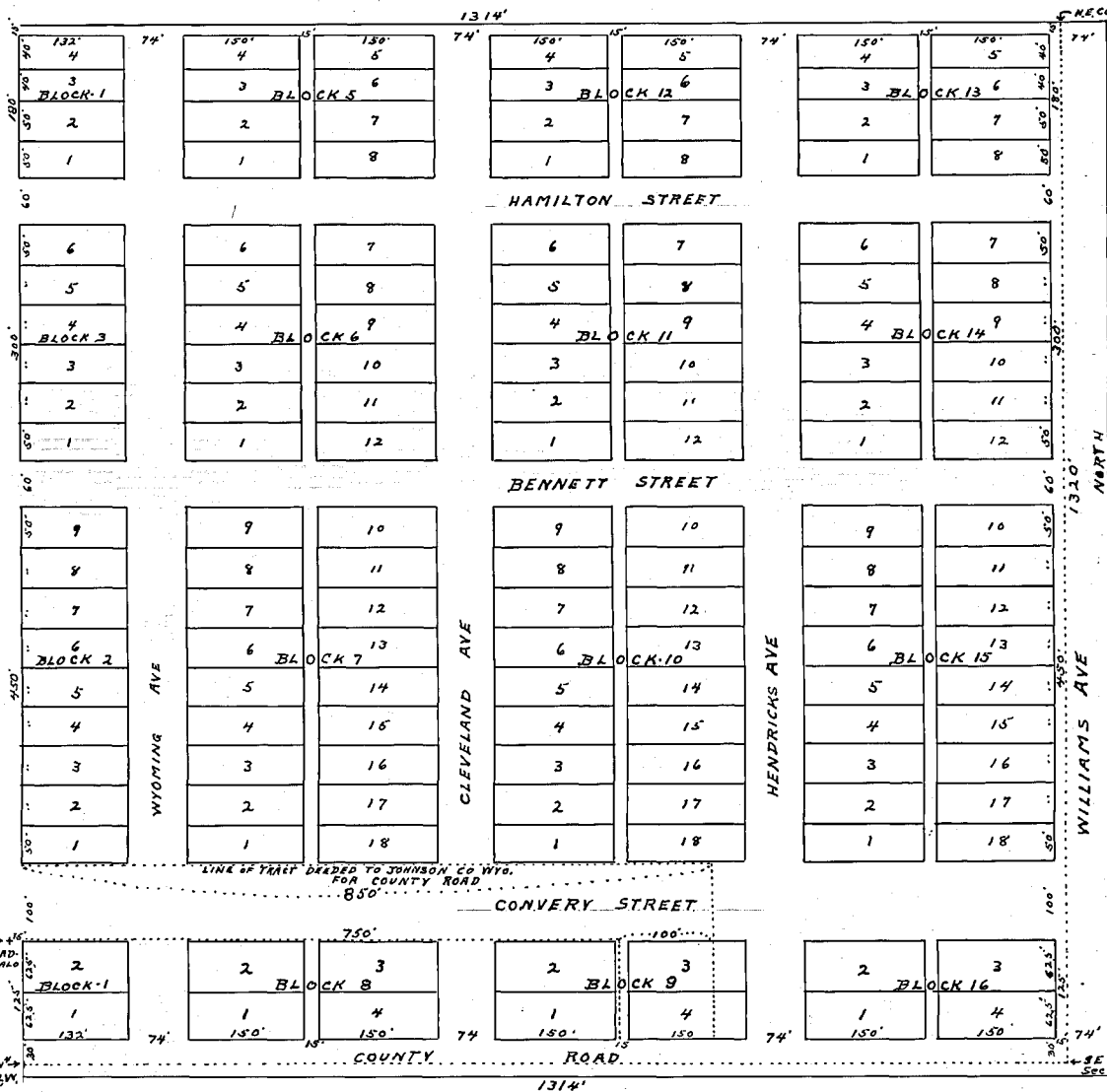

No 5193

Office of Register of Deeds }
COUNTY OF JOHNSON }

I hereby certify that the within instrument was filed in this office for Record on the 13th day of June A. D. 1904, at 2:20 o'clock P. M. and was duly recorded in Book _____ of Plats Page _____

S. B. Cochran
Register of deeds

State of Wyoming
County of Johnson

The above, foregoing and annexed Subdivision of the following described tract of land, to-wit:

A strip of land fifty nine (59) feet wide and thirteen hundred and twenty (1320) feet long off the west side of the North West Quarter of the South East Quarter (NW¹/₄ SE¹/₄) of Section Thirty Five (35) Township Fifty one (51) North of Range Eighty two (82) West and more particularly described as follows: Beginning at the south West corner of the said Subdivision Fifty Nine (59) feet; thence northward thirteen hundred and twenty (1320) feet more or less to the north line of said subdivision; thence westward fifty nine (59) feet to the west line of said subdivision; thence southward along the west boundary of said subdivision to the place of beginning; Also all of the North East Quarter of the South West Quarter (NE¹/₄ SW¹/₄) of section thirty five (35) Township Fifty one (51) North of Range Eighty Two (82) West, excepting that portion lying south and west of the North and East line of Road Survey N 279 of Johnson County as the same appears of record, said excepted tract being approximately 257 feet wide and 850 feet long and extending from the south West corner of said Subdivision easterly along the south line thereof

As said subdivision of the tract above described appears on this plat, is with the free consent and in accordance with the desires of the undersigned owner and proprietor

Buffalo Wyoming June 11-1904
witness; T.P. Hill
W.J. Thom.
O.A. Stillman.

State of Wyoming }
County of Johnson }

Before me this day appeared W.J. Thom and O.A. Stillman, to me personally known to be the identical persons who signed and executed the above dedication of a plat and acknowledged that they signed and executed the above as their free and voluntary act for the purposes of a city addition as therein provided

Witness my hand and seal of office at Buffalo Wyoming this 11th day of June 1904
T. P. Hill
Notary Public.
my com. ex Dec. 17-1904

CERTIFICATE OF SURVEYOR

State of Wyoming }
County of Johnson }

I, Clyde R. Wood of Buffalo Wyoming hereby certify that this map was copied by me from the original map of Hamilton Addition to Buffalo Wyoming and that this map is correct only in-so-far as the original map is correct

copied Aug 10-12-1904

Clyde R. Wood
COUNTY SURVEYOR
State Registration No. 151

HAMILTON
ADDITION
BUFFALO WYOMING
scale 1" = 120'